

STRAIGHT SHOT™ MOUNTING INSTRUCTIONS

OJD & Drill Rebounders

Before working on your planter or drill

DANGER: When storing or working on the planter or drill always install cylinder stops or place it on stands to prevent personal injury or damage to the attachments.

PLEASE: Read instructions completely and verify all package contents before beginning installation.

Straight Shot Package Contents (per single row)	
Item	Quantity
Straight Shot	1
Threaded Female QC	1
1/4" Hose	1
Metal Plate	1
L-Bracket	1
Washer	1
Propeller T Nut	1
Screws for T Nut Slotted	1
14 x 3/8" Screws	2
Instruction Sheet	1

- Take the propeller t-nut (fig. A) and insert it into the back side of one of the upper holes of the drill Rebounders (fig. B) or into the hole on the back side of the sawtooth insert on the OJD John Deere planter type Rebounder.
- Place the L-bracket (fig. D) with the small hole down on the Rebounder with the washer (fig. E) on top, over the hole of the propeller t-nut.
- Using screwdriver, tighten the round-head slotted 10-24 x 3/8" screw (fig. F) into the propeller t-nut.
- Thread the 1/4" tube x 1/8" female NPTF (fig. G) into the Straight Shot.
- Set the Rebounder upside down. Drill a 5/32" hole on the top side of the Rebounder, 1-3/4" from the end of drill Rebounders or 2" from the end of OJD Rebounders, grooving the hole at a 35° angle to the Rebounder (fig. I). This angle directs the flow to the seed.
- Place the Straight Shot between the moded tabs. Place the plate over the Straight Shot and install the two #14 x 3/8" pan phillips type screws (fig. J).
- Run the hose through the L-bracket on the Rebounder and push the hose into the Quick Coupler on the Rebounder. To remove hose from the Quick Coupler, press ring down around the hose against the Quick Couple so that the hose will release (fig. K).
- Follow Rebounder Mounting Instructions for mounting the Rebounder.

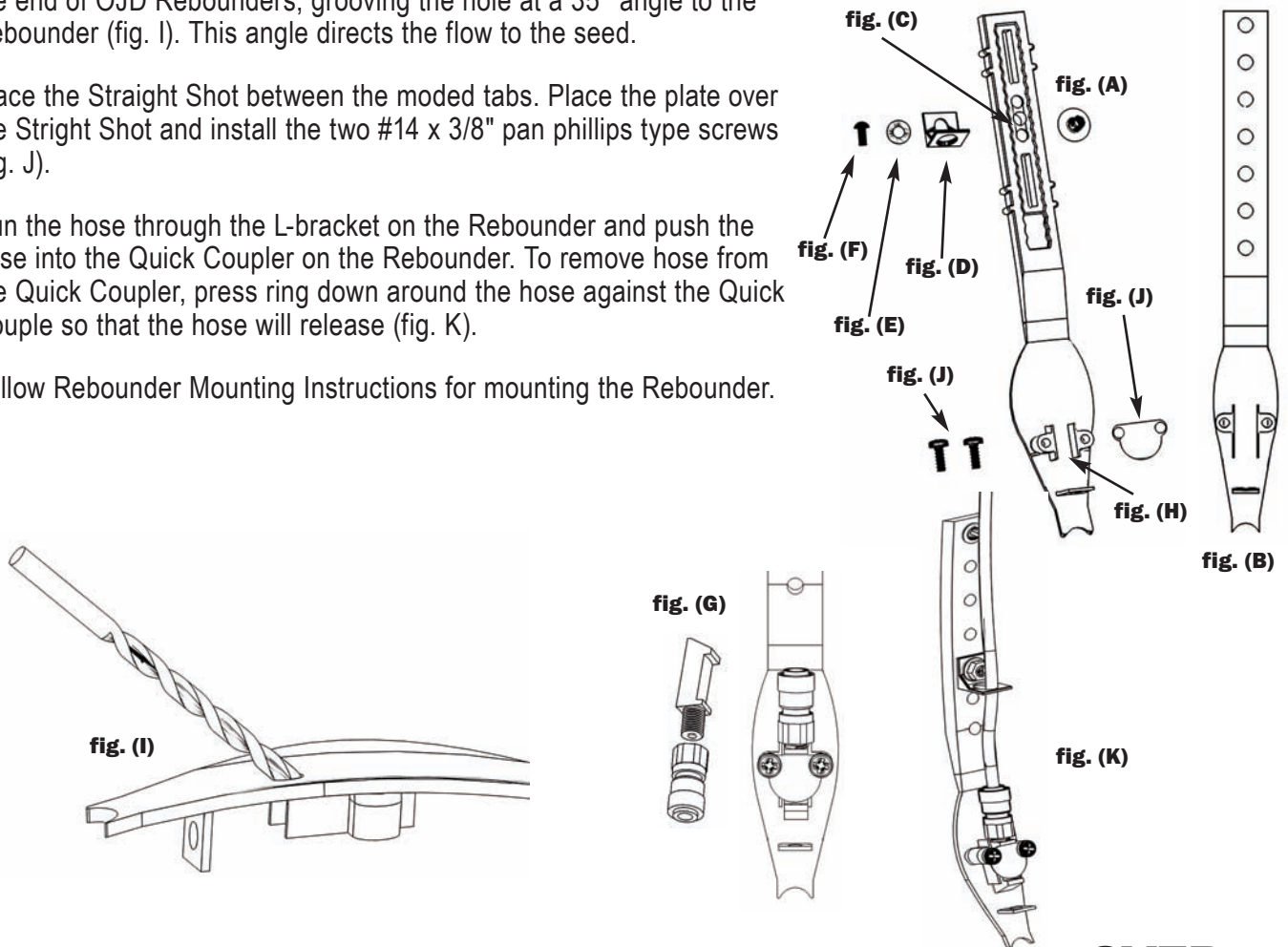

OVER →

STRAIGHT SHOT™ MOUNTING INSTRUCTIONS

Drilling the Hole in OJD & Drill Rebounders

Set the Rebounder upside down.

Drill a 5/32" hole on the top side of the Rebounder.

For Drill Rebounders make this hole 1-3/4" from the end;
 for OJD sawtooth Rebounders make the hole 2" from the end.
 Drill the hole in the center of the Rebounder.

Groove the hole at a 35° angle.

This angle directs the flow to the seed.

